



A modern office tower that combines striking architecture and interiors with high-level functionality



Standing at 26 storeys, **One Global Place** combines striking architecture and interiors with a high-level functionality. Steel, glass, granite and marble combine to create a refined, modern design. With office units of varying sizes, One Global Place provides tenants with flexibility and options suited to their needs.



Location

5th Avenue corner 25th Street, Bonifacio Global City, Taguig City, Philippines



Floor Plate

1,014 sqm



Gross Leasable Area

18,829 sqm



Ceiling Height

2.5 meters (office)



No. of Floors

26 storeys



Structural Consultant

Sy^2 + Associates



Completion Year

2010



Architect

Aidea



TRUST BANK

realfood

indus

Interior and Exterior

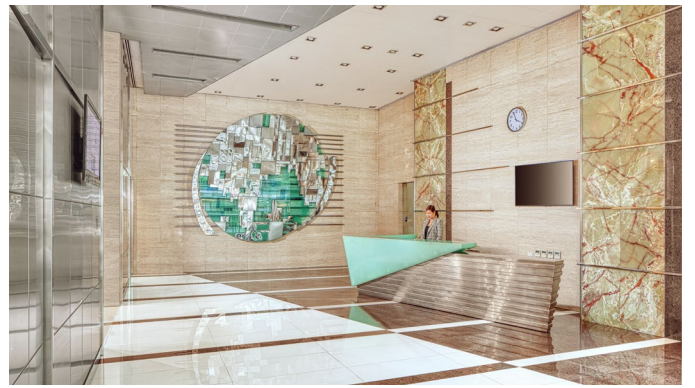



Property Features



Retail establishments on the ground floor



High capacity elevators with efficient lift management system



VRF multi-split air conditioning system



Fully unitized curtain wall with resilient window system made of heat resistant glass and UV reduction characteristics



Balanced use of glass and wall covering for maximum view



100% back-up power with redundant busduct riser

Certification



PEZA Registered

FOR LEASING INQUIRIES

marketing@dpdiph.com

Daiichi Properties

Penthouse, The Finance Centre, 26th St cor. 9th Ave.,
Bonifacio Global City, Taguig, Metro Manila, Philippines
T 632 8636-8888
F 632 8636-1000